

## Inspiration Developer Landscape Updates

07.16.2020

Please do not walk or allow your pets to do their 'business' on newly seeded areas. Native vegetation is especially fragile when the seed is germinating. Humans and pets even walking on new seed causes damage and will hinder establishment.

### Filing 8 Tract A and F

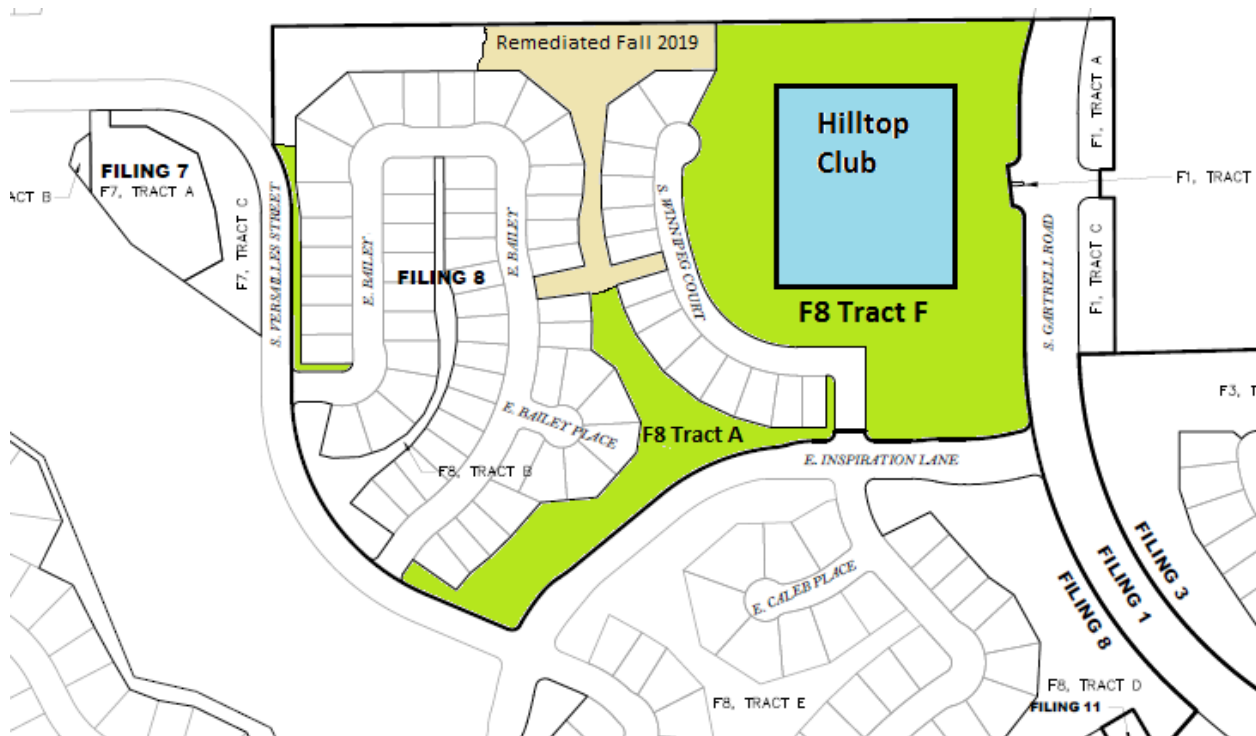

- **F8 Tract A North:** This area was mowed the week of June 22<sup>nd</sup> after existing vegetation dropped their seeds. Locations where seed did not establish from the fall 2019 application will have their blankets pulled back compost, seed and fertilizer added and blankets re-set.
- **F8 Tract A South:** Seed and hydromulch was applied the week of July 6<sup>th</sup>.
- **F8 Tract A corner of Versailles and Bailey:** Holes were filled, landscape bed re-set with plants, mulch and rock and bare spots were seeding/hydromulched the week of July 6<sup>th</sup>. We will continue to watch this area. There is a lot of sump water coming from homes. We may need to take action to mitigate drainage.
- **F8 Tract F:** Finalizing bid details for watering of new seed where irrigation is not in place (Northwest of tennis courts and area between parking lot and Gartrell) and finalizing tree/plant replacement. Higher temperatures are leading us to wait on new plantings, but dead trees will be cut down as soon as possible and new trees will be planted as soon as possible.

### Filing 10 Phase 2:

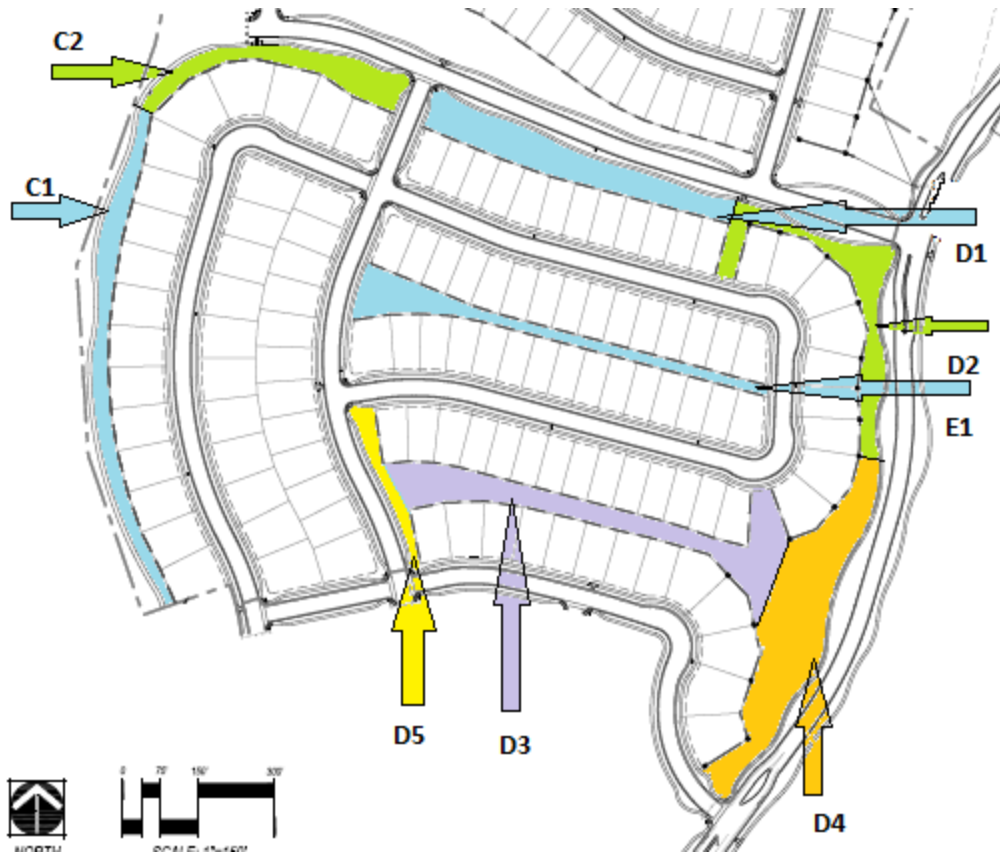

- **D2:** Irrigation was damaged the week of June 29<sup>th</sup> when digging occurred. Tech was on site last Wednesday July 8<sup>th</sup> to make repairs and turn system back on.
- **D2:** Fence was removed for grading work and reinstalled. Fence was also removed for installation of a communication box. All fencing will be re-installed and stained.
- **D1, D2, D4 and E1:** Reseeding was planned for the week of July 6<sup>th</sup>, but additional dirt work occurred and repairs were put on hold. Landscaper will re-assess the current repair scope and likely increase the scope based on recent activity.
- **D1 and D4:** Landscape beds need to be reestablished after damage.
- **C1:** South end of trail near the park needs re-seeding. This work will be completed but large trucks/machines cannot reach this area so it is separate from other seeding.