

## Inspiration Developer Landscape Updates

07.22.2020

Please note:

\* Do not walk or allow your pets to do their 'business' on newly seeded or newly sodded areas. Native vegetation is especially fragile when the seed is germinating. Humans and pets even walking on new seed or sod causes damage and will hinder establishment.

\* It is Newland and District maintenance policy to mow 'beauty bands' along common fences. This is done to manage wild life, ensure access for fence or landscape maintenance and to provide a neat appearance. The band is one mower width (approximately 4 feet). When mowing occurs, all vegetation along the fence will be cut. This includes any flowers or plants that were installed by homeowners in the common area. Homeowners are not allowed to plant anything in the common areas.

\* Homeowners are responsible for excessive drainage off their lots. Excessive is defined by causing damage, erosion or pooling to common areas or neighboring lots. Please be aware of your irrigation. It may be better to irrigate multiple times for short periods instead of once for a longer time to allow water to seep into the ground and not run off.

### Filing 8 Tract A and F

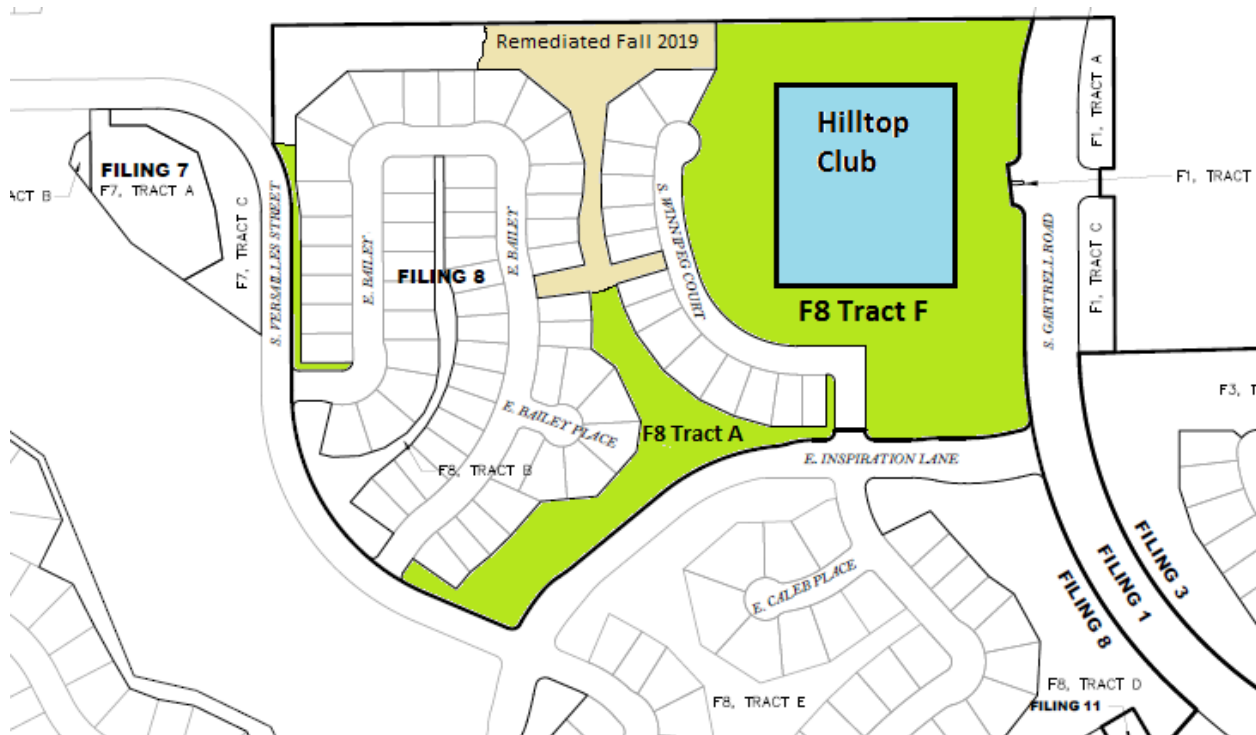

- **F8 Tract A North:** Existing vegetation dropped their seeds as expected enabling further growth. Locations where seed did not establish from the fall 2019 application will have their blankets pulled back compost, seed and fertilizer added and blankets re-set.
- **F8 Tract A South and adjacent native tree lawn:** Seed and hydromulch were applied the week of July 6<sup>th</sup>. This area is being irrigated.
- **F8 Tract A corner of Versailles and Bailey:** Repairs completed. We will continue to watch this area. There is a lot of sump water coming from homes. We may need to take action to mitigate drainage.
- **F8 Tract F:** Finalizing bid details new seed and tree replacement. Higher temperatures are leading us to wait on new plantings, but dead trees will be cut down as soon as possible and new trees will be planted as soon as possible.

## Filing 10 Phase 2:

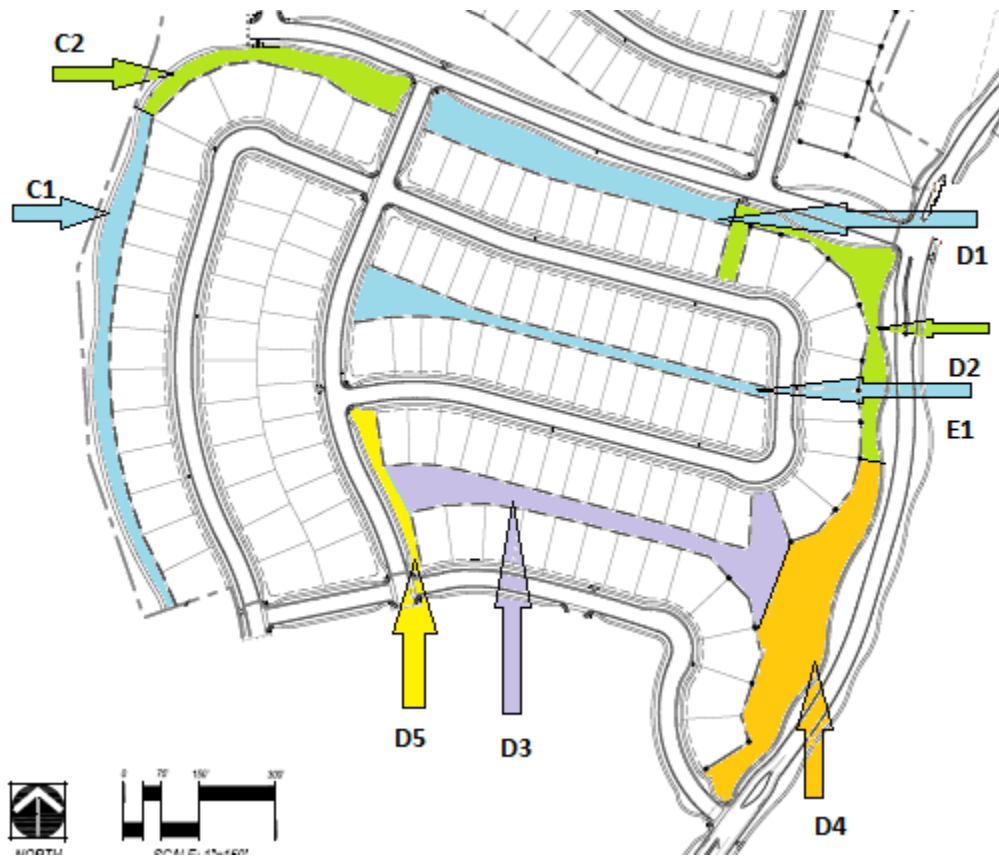

- **Weed Management:** We are planning on spot weed spraying in all areas. Weeds will not be cut down. Weeds will only be sprayed so that plant and seeds are killed.
- **C1:** South end of trail near the park needs soil amendments, re-seeding and fertilizing. This work is being completed separate from other areas because of access. The north end of the tract is well –established.
- **C2:** Irrigation was reviewed on 7/20 and excessive water was noted. There was a drip line that had a break. Irrigation tech will review and make necessary corrections/suggestions.
- **D1:** The week of July 6<sup>th</sup>, a drain ‘trench’ was installed from the west side to the sloped area to move water along. Seed was installed under the blanket and new grass is coming through. The area was walked on 7/20 and there is still excessive water. We are working with the irrigation tech and the landscaper to manage water, but also repair vehicle damage and re-seed accordingly.
- **D2:** Landscape beds need to be re-established and dead materials replaced. Grade and seed repairs are needed after lot work occurred in the easement.
- **D1, D2, D4 and E1:** Landscaper has re-assessed the current repair scope and has increased the scope based on recent activity.
- **D1 and D4:** Landscape beds need to be reestablished after utility damage.
- **D3 and D5:** Seed has established as expected and no further seeding will occur at this time.

Engineering plans for the construction of 3 access ramps at the mailbox kiosks south of Fletcher Drive were approved by the City of Aurora on July 16, 2020. Newland will be finalizing bids, selecting a contractor and proceeding with a contract to install these access ramps. Work is anticipated to start in early August and be completed by the end of August.